

# Low – Medium Power Thermal Sensors – Apertures to 35mm

## 50mW to 150W

### Features

- Special purpose SV, HE and HE absorbers
- For concentrated beams and pulses
- Convection air cooled
- CW to 30 or 50W, intermittent to 150W
- 17mm and 35mm apertures

L50(150)A-EX-35



Model	L50(150)A-EX-35	
Use	Excimer lasers	
Absorber Type	EX	
Spectral Range $\mu\text{m}$	0.15 – 0.7, 10.6	
Aperture mm	$\phi$ 35mm	
Power Mode		
Power Range	100mW - 150W	
Maximum Intermittent Power W	150W for 1.5min, 100W for 2.5min, 50W continuous	
Power Scales	150W / 50W / 5W	
Power Noise Level	4mW	
Maximum Average Power Density KW/cm <sup>2</sup>	2	
Response Time with Display (0-95%) typ. s	2	
Power Accuracy +/-%	3	
Linearity with Power +/-%	1.5	
Energy Mode		
Energy Range	40mJ - 300J	
Energy Scales	300J / 30J / 3J	
Minimum Energy mJ	40	
Damage Threshold J/cm <sup>2</sup>	Pulse width	
	<100ns	0.5
	0.5ms	5
	2ms	12
	10ms	25
Cooling	convection / ballistic	
Fiber Adapters Available (see page 44)	NA	
Weight Kg	0.35	
Version		
Part number	7Z02697	

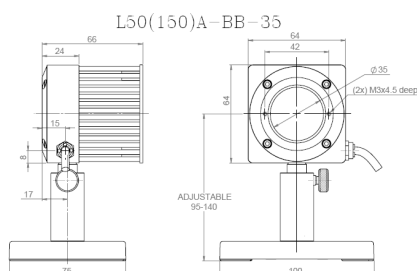

Rev8/spc/01.01.12/eg